

Technical Data Sheet - Synchra / MZ Magnetic Coupling
Non-Contact Power Transmission For High Speed / ATEX  h IIC T6 Gc

No Slip Heavy Duty Magnetic Couplings

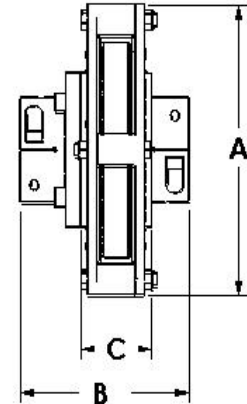



- 100% recyclable (Synchra)
- Non Slip Magnetic Couplings
- ATEX Rating – No instrumentation Required
- Overload Protection
- Heavy Duty Construction
- Accepts Large Misalignment
- Eliminates Vibration Transfer
- Absorbs Shock Loading
- Low Maintenance
- Simple Installation
- Reduces O&M Costs
- Increases Seal & Bearing Life
- Precise Torque Trip and Repeatable

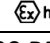

 h IIC T6 Gc

Synchra data									
	Power rating*	Power rating*	Peak torque rating		Max. std RPM	Wt. (less hubs)	Dimensions (inches)		
	1800 RPM	3600 RPM	ft-lbs	in-lbs		lbs.	Dia. (A)	Length (B)	Length (C)
Up to	1500.00	750.00	6127.33	73528	3600	45 to 537	Up to 28	Up to 13.5	Up to 5

ATEX Rating	Zone 2  h IIC T6 Gc
max. speed	3600 RPM
max. torque	Up to 152988 in-lb
max. offset of shafts radial / axial	0.375" / 0.200"
mimimum DBSE	0.25"
Maximum DBSE	Up To 8"
moment of inertia	Up to 42,000 lb-in ²
Max diameter	Up to 28"
temperature range	250 F
weight appr.	Up To 537 lbs
Material Of Construction, Magnetic Center 	Steel A-36 , Al 6061-T6, Neodymium, IRON, Boron
RPM Slip	0
Material Hub Fasteners	SHCS, ASTM A574, Anti Corrosive
Corrosion Properties	Zinc / Special / Anodizing / Martenized