

Technical Data Sheet - Vortex Magnetic Coupling

Under 100 HP Non-Contact Power Transmission

Standard Magnetic Coupling for Centrifugal Applications



- 100% Recyclable
- Accepts Large Misalignment
- Cushioned Start
- Eliminates Vibration Transfer
- Absorbs Shock Loading
- Low Maintenance
- Simple Installation
- Reduces O&M Costs
- Increases Seal & Bearing Life

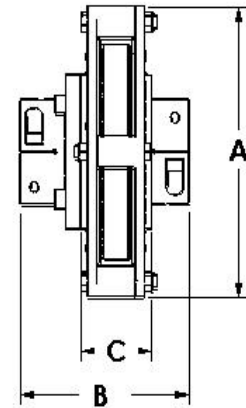

Vortex data									
Coupling Model	Power rating*	Power rating*	Peak torque rating		Max. std RPM	Wt. (less hubs)	Dimensions (inches)		
	1800 RPM	3600 RPM	ft-lbs	in-lbs		lbs.	Dia. (A)	Length (B)	Length (C)
VTX-07	15.00	30.00	91.7	1100	6800	20	9.25	6.06	2.50
VTX-11	50.00	100.00	325	3900	4500	49	13.13	6.60	2.50

	Vortex 07	Vortex 11
max. speed	6800 RPM	4500 RPM
max. torque	1100 in-lb	3900 in-lb
max. offset of shafts radial / axial	0.250" / 0.125"	0.250" / 0.125"
mimimum DBSE	0.25"	0.25"
maximum DBSE	3.5"	3.5"
moment of inertia	252 lb-in ²	1200 lb-in ²
max diameter	9.25"	13.13"
temperature range	250 F	250 F
weight appr.	32 lbs	69 lbs
Material Of Construction, Magnetic Center 	Steel A-36 , Al 6061-T6, Copper C11000 Neodymium, Iron, Boron	Steel A-36 , Al 6061-T6, Copper C11000 Neodymium, Iron, Boron
RPM Slip	< 5%	< 5%
Material Hub Fasteners	SHCS, ASTM A574,	SHCS, ASTM A574,
Corrosion Properties	Black Oxide / Anodizing	Black Oxide / Anodizing